

STAINLESS STEEL THREADED END GATE VALVE

Model : JY-200T

Design feature:

- Applications for Hydraulic, Chemical, Steam, Oil/ Gas, Oxygen, Vacuum.
- Investment Cast Stainless Steel Body & Bonnet.
- Handle wheel operated.
- Non-rise stem, Wedge Disc.
- Integral Stainless Steel Seat.
- din EN10204-3.1 Certificate Available



Specifications:

- Flow bore: full port.
- Rating: 200 CWP
- Temperature: -20°C - 180°C
- Materials: ASTM A351 CF8M, 1.4408
- Size range: 1/2"-2"

Standard:

- Basic Design to ANSI B16.34
- Female Thread: NPT, PT, DIN 2999(Rp), ISO-228(G).
- Inspection & testing according to API 598.
- PED 97/23/EC; ISO 9001

Dimensions List:

INCH	d	H	L	D	Weight KG
1/2"	15	95	55	70	0.48
3/4"	20	102	60	70	0.6
1"	25	115	65	80	0.8
1-1/4"	32	127	75	80	1.2
1-1/2"	38	150	85	90	1.6
2"	50	170	95	100	2.3

MATERIALS LIST :

NO	PARTS NAME	SPECIFICATION
1	BODY	CF8M/ 1.4408
2	GASKET	PTFE
3	DISC	SS316
4	STEM HOLDER	SS316
5	STEM	SS316
6	BONNET	CF8M/ 1.4408
7	STEM PACKING	PTFE
8	PACKING GLAND	SS304
9	PACKING NUT	SS316
10	HANDLEWHEEL	MICO STEEL
11	NAME PLATE	ALUMINUM
12	WASHER	SS304
13	NUT	SS304

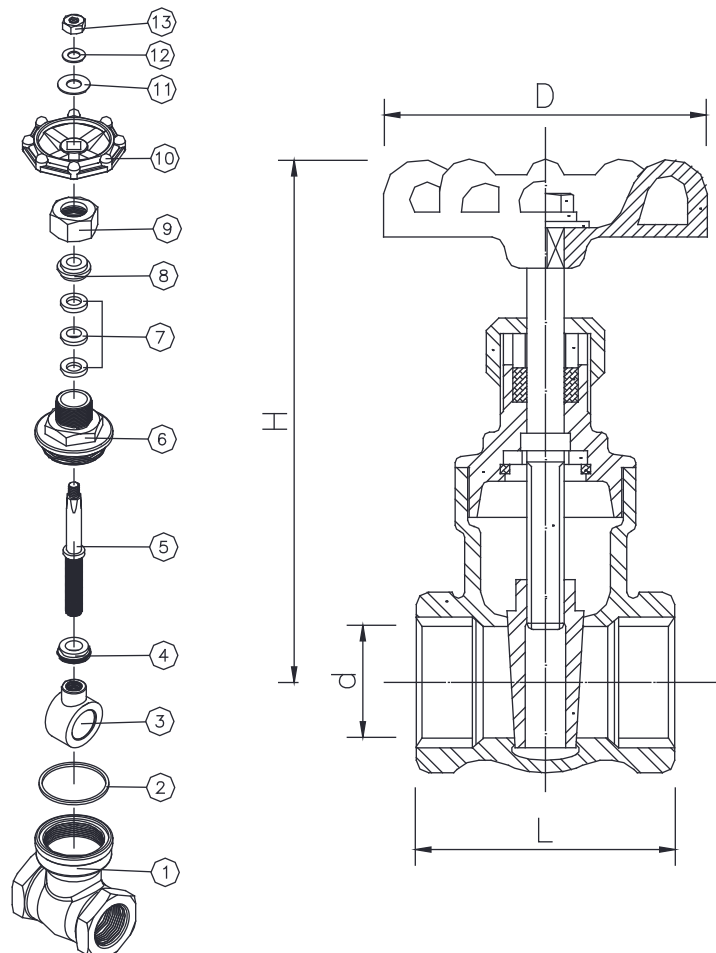

Die Erste remains the right to adjust the spec of this model without further